

## Wide-Range Reduzierkupplung (U-Stück)

Reduzierkupplung zur Anbindung von Rohren unterschiedlicher Materialien (Stahl, Guss, Duktil-Guss, Asbestzement, PVC, PE-HD/PEX).

- Gehäuse und Folgering aus Stahl
- Korrosionsschutz Rilsan (min. 250 µm gem. GSK)
- Schrauben und Muttern verzinkt/theraplexbeschichtet bzw. aus Edelstahl
- Dichtungswerkstoff EPDM
- Durchmessertoleranz max. 17 mm
- Abwinklung der Rohre von max. 6 Grad möglich
- Temperaturbereich: -20°C - +30°C

### Hinweis:

Bei der Anwendung auf PE-HD/PEX-Rohren ist unsere Innenstützhülse SHVA erforderlich Alternativ empfehlen wir das längskraftschlüssige Produkt FRIAGRIP.

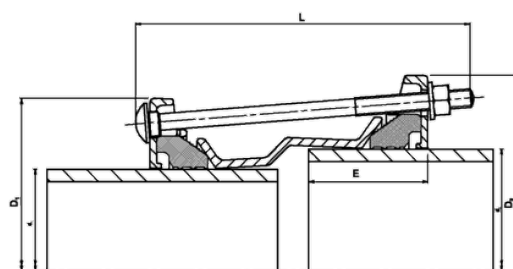

Schrauben verzinkt und theraplexbeschichtet

Dichtung EPDM, DIN-EN 681-1 / KTW / UBA / DVGW-W270

PFA/PN Wasser = 16 bar

Artikel	DN	d <sub>1</sub>	d <sub>2</sub>	L	Gewicht [kg]	VE
GB-99R9-315351	300	315,0-332,0	351,0-368,0	230	44,000	1
GB-99R9-315367	300	315,0-332,0	367,0-384,0	230	22,300	1
GB-99R9-351374	350	351,0-368,0	374,5-391,5	300	32,400	1
GB-99R9-374394	350	374,5-391,5	394,3-411,3	300	34,500	1

## Wide-Range Reduzierkupplung (U-Stück)

Artikel	DN	d <sub>1</sub>	d <sub>2</sub>	L	Gewicht [kg]	VE
GB-99R9-374404	350	374,5-391,5	404,8-421,8	300	36,500	1
GB-99R9-394418	350	394,3-411,3	418,2-435,2	300	36,500	1
GB-99R9-394425	350	394,3-411,3	425,0-442,0	300	35,600	1
GB-99R9-404425	400	404,8-421,8	425,0-442,0	300	38,800	1
GB-99R9-425434	400	425,0-442,0	434,4-451,4	300	38,900	1
GB-99R9-425447	400	425,0-442,0	447,0-464,0	300	39,100	1
GB-99R9-425455	400	425,0-442,0	455,0-472,0	300	39,500	1
GB-99R9-425476	400	425,0-442,0	476,0-493,0	300	39,500	1
GB-99R9-425487	400	425,0-442,0	487,0-504,0	300	68,000	1
GB-99R9-447455	400	447,2-464,2	455,0-472,0	300	49,500	1
GB-99R9-447476	400	447,2-464,2	476,0-493,0	300	43,000	1
GB-99R9-447501	400	447,2-464,2	501,9-518,9	300	43,000	1
GB-99R9-447510	400	447,2-464,2	510,0-527,0	300	43,600	1
GB-99R9-447540	400	447,2-464,2	540,1-557,1	300	47,400	1
GB-99R9-476487	400	476,0-493,0	487,3-504,3	300	42,700	1
GB-99R9-476501	400	476,0-493,0	501,9-518,9	300	43,000	1
GB-99R9-476510	400	476,0-493,0	510,0-527,0	300	43,600	1
GB-99R9-487527	400	487,0-504,0	527,0-544,0	300	47,700	1
GB-99R9-501527	500	501,0-518,0	527,0-545,0	300	47,700	1
GB-99R9-510527	500	510,0-527,0	527,0-545,0	300	47,700	1
GB-99R9-528540	500	527,0-544,0	540,1-557,1	300	47,400	1
GB-99R9-528555	500	527,0-544,0	555,3-572,3	300	47,600	1
GB-99R9-528566	500	527,0-544,0	566,5-583,5	300	47,800	1
GB-99R9-528582	500	527,0-544,0	582,2-599,2	300	48,000	1
GB-99R9-527598	500	527,0-544,0	598,0-615,0	300	48,000	1
GB-99R9-527601	500	527,0-544,0	601,0-618,0	300	48,000	1
GB-99R9-527630	500	527,0-544,0	630,0-647,0	300	48,000	1
GB-99R9-555566	500	555,3-572,3	566,5-583,5	300	47,800	1
GB-99R9-598630	600	598,0-615,0	630,0-647,0	300	56,100	1
GB-99R9-601630	600	601,0-618,0	630,0-647,0	300	56,100	1
GB-99R9-630645	600	630,0-647,0	645,2-662,2	300	55,800	1
GB-99R9-630662	600	630,0-647,0	662,0-679,0	300	56,100	1
GB-99R9-630675	600	630,0-647,0	675,0-692,0	300	57,000	1

**WRKR**

## Wide-Range Reduzierkupplung (U-Stück)

Schrauben Edelstahl

Dichtung EPDM, DIN-EN 681-1 / KTW / UBA / DVGW-W270

PFA/PN Wasser = 16 bar

Artikel	DN	d <sub>1</sub>	d <sub>2</sub>	L	Gewicht [kg]	VE
GB-99R9X315351	300	315,0-332,0	351,0-368,0	230	32,100	1
GB-99R9X315367	300	315,0-332,0	367,0-384,0	230	22,300	1
GB-99R9X351374	350	351,0-368,0	374,5-391,5	300	34,200	1
GB-99R9X374394	350	374,5-391,5	394,3-411,3	300	34,500	1
GB-99R9X374404	350	374,5-391,5	404,8-421,8	300	36,500	1
GB-99R9X394418	350	394,3-411,3	418,2-435,2	300	36,500	1
GB-99R9X394425	350	394,3-411,3	425,0-442,0	300	37,500	1
GB-99R9X404425	400	404,8-421,8	425,0-442,0	300	37,500	1
GB-99R9X425434	400	425,0-442,0	434,4-451,4	300	38,900	1
GB-99R9X425447	400	425,0-442,0	447,0-464,0	300	39,100	1
GB-99R9X425455	400	425,0-442,0	455,0-472,0	300	39,500	1
GB-99R9X425476	400	425,0-442,0	476,0-493,0	300	55,000	1
GB-99R9X425487	400	425,0-442,0	487,0-504,0	300	68,000	1
GB-99R9X447455	400	447,2-464,2	455,0-472,0	300	39,500	1
GB-99R9X447476	400	447,2-464,2	476,0-493,0	300	43,000	1
GB-99R9X447501	400	447,2-464,2	501,9-518,9	300	43,000	1
GB-99R9X447510	400	447,2-464,2	510,0-527,0	300	43,600	1
GB-99R9X447540	400	447,2-464,2	540,1-557,1	300	47,400	1
GB-99R9X476487	400	476,0-493,0	487,3-504,3	300	42,700	1
GB-99R9X476501	400	476,0-493,0	501,9-518,9	300	43,000	1
GB-99R9X476510	400	476,0-493,0	510,0-527,0	300	43,600	1
GB-99R9X487527	400	487,0-504,0	527,0-545,0	300	47,700	1
GB-99R9X501527	500	501,0-518,0	527,0-545,0	300	47,700	1
GB-99R9X510527	500	510,0-527,0	527,0-545,0	300	47,700	1
GB-99R9X528540	500	527,0-544,0	540,1-557,1	300	47,400	1
GB-99R9X528555	500	527,0-544,0	555,3-572,1	300	47,600	1
GB-99R9X528566	500	527,0-544,0	566,5-583,5	300	47,800	1
GB-99R9X528582	500	527,0-544,0	582,2-599,2	300	48,000	1
GB-99R9X527598	500	527,0-544,0	598,0-615,0	300	63,000	1
GB-99R9X527601	500	527,0-544,0	601,0-618,0	300	48,000	1
GB-99R9X527630	500	527,0-544,0	630,0-647,0	300	48,000	1

**WRKR****Wide-Range Reduzierkupplung (U-Stück)**

Artikel	DN	d <sub>1</sub>	d <sub>2</sub>	L	Gewicht [kg]	VE
GB-99R9X555566	500	555,3-572,3	566,5-583,5	300	47,800	1
GB-99R9X598630	600	598,0-615,0	630,0-647,0	300	56,100	1
GB-99R9X601630	600	601,0-618,0	630,0-647,0	300	56,100	1
GB-99R9X630645	600	630,0-647,0	645,2-662,2	300	55,800	1
GB-99R9X630662	600	630,0-647,0	662,0-679,0	300	56,100	1
GB-99R9X630675	600	630,0-647,0	675,0-692,0	300	57,000	1