

ODBC - Flansch der ISO-DIN-Serie

Blindflansch aus PP/FRP beschichtetem Stahl EN/ISO/DIN. Bohrung: PN 10/16

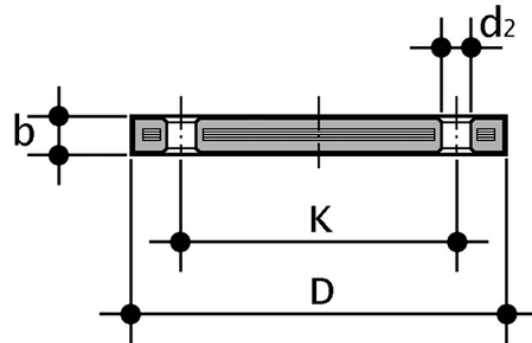

Artikel	d	DN	product.detail.attribute.PMA (bar)	product.detail.attribute.b	product.detail.attribute.d[5:2]	D	product.detail.attribute.k
ODBC020	20	15	10	16	14	95	65
ODBC025	25	20	10	12	18	105	75
ODBC032	32	25	10	18	14	115	85
ODBC040	40	32	10	17	18	140	100
ODBC050	50	40	10	18	18	150	110
ODBC063	63	50	10	18	18	165	125
ODBC075	75	65	10	18	18	185	145
ODBC090	90	80	10	20	18	200	160
ODBC110	110	100	10	20	18	220	180