

MB SDR 11

Coupler with removable inner stop, SDR 11

Coupler MB SDR 11 with inner stop

- Gas, water and H₂
- Working pressure: MOP (gas) 10 bar, PFA (water) 16 bar
- Material: PE 100-RC
- Easily removable inner stop
- Safety technology
- Large insertion depth for good pipe routing (no holding devices required)
- DVGW test mark: DV-8601AU2248 and DV-8606AU2249

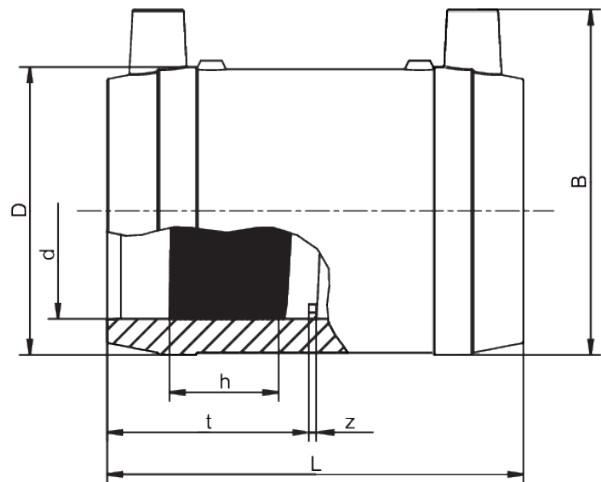

PE 100-RC SDR 11

Maximum permissible working pressure 16 bar (water) / 10 bar (gas)



Reference	Diameter	SDR range	B	D	h	L	t	z	Weight [kg]	BX	Pallet quantity
612680	20	7,4 - 11	49	33	17	60	29	2	0,040	110	3520
612681	25	7,4 - 11	54	38	17	66	32	2	0,060	100	3200
612682	32	7,4 - 11	61	45	21	78	38	2	0,070	80	2560
612683	40	7,4 - 11	71	54	23	86	42	2	0,090	40	1280
612684	50	11 - 17,6	82	68	27	98	48	2	0,150	25	800
612685	63	11 - 17,6	96	82	29	110	55	2	0,230	18	576
612686	75	11 - 17,6	110	98	32	122	60	3	0,330	50	400
612687	90	11 - 17,6	127	114	51	157	77	3	0,440	40	320
612688	110	11 - 17,6	152	137	49	159	78	3	0,710	24	192
612689	125	11 - 17,6	169	156	51	172	85	3	0,940	18	144
612690	140	11 - 17,6	185	174	52	184	91	3	1,270	12	96
612691	160	11 - 17,6	207	199	52	190	94	3	1,780	8	64

MB SDR 11

Coupler with removable inner stop, SDR 11

Areas of Application

The FRIALEN-coupler MB is used for pipe connections when laying long runs. Additional areas of application:

- Integration of adapters into an existing pipe-line
- Connection of pipelines with fixed or restraint points
- Reinforcement / sealing of localised pipe damage
- Reinforcement of pinch points

FRIALEN safety fittings can be fused with SDR11 – SDR17.6 pipes. Other levels of SDR can be processed on request. Please note the mandatory labels directly on the product. DVGW test marks issued: DV-8601AU2248 and DV-8606AU2249

Assembly Instructions

The fusion of pipe ends with the FRIALEN-coupler MB takes place using FRIALEN-fusing – leakproof and longitudinally strong.

The pipe ends are prepared according to the general installation instructions (see "Assembly Instructions" for "FRIALEN-Safety Fittings for house connections and distribution pipes up to d 225"). This involves removing the oxide skin and cleaning the pipe ends. Please note that spigot of valves must be at least half as long as the coupler.

Good reasons for using the FRIALEN Coupler MB:

- Large coupler depth for ease of pipe guiding (no holding clamps required)
- Extra wide fusion zones
- Maximum stability through great wall thickness
- Cold zones at the front side and in the middle of the coupler
- Exposed heating coil for direct heat transmission to the pipe
- Small annular gap for build-up of optimum joining pressure in the fusion zone
- Touch proof electric contacts
- Fusion indicator for visual fusion control
- Durable batch marking
- Individually wrapped for dirt protection
- Additional barcode for tracing back the fitting (Traceability-Coding)