

USTR

Transition fitting EF coupler / steel pipe

Transition fitting EF coupler / steel pipe USTR

- Gas and H₂
- Working pressure: MOP (gas) 10 bar
- Material: PE 100-RC and steel (EN 10220 / EN 10216-1 - P235TR2)
- Safety technology

Note:

Anchored the steel side non-detachable and non-rotatable in the PE.

Self-sealing, patented sealing geometry without elastomeric gasket for use in gas applications.

Steel pipe batch characterised by re-stamping of the pipe connection.



d/DN 25/20-75/65

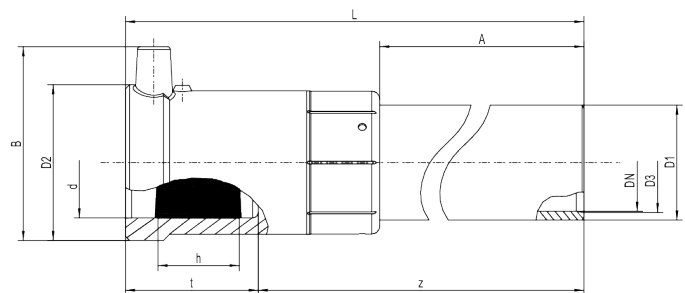

PE 100-RC SDR 11

Maximum permissible working pressure 10 bar (gas)



	Reference	Diameter	DN	A	B	D2	d3	h	L	t	z	Weight [kg]	BX	Pallet quantity
1	612780	32	25	300	63	49	28	24	387	44	343	0,810	15	360
1	612781	40	32	300	72	58	37	31	393	49	344	1,610	10	240
1	612782	50	40	300	83	70	42	31	409	54	355	2,100	8	192
1	612783	63	50	300	96	83	54	33	410	55	355	2,020	6	144
1	612784	90	80	255	130	130	83	42	405	79	326	5,320	1	77
1	612785	110	100	255	153	153	107	35	420	82	338	8,390	1	54
1	612786	125	100	255	168	168	107	42	425	87	338	8,710	1	45
	612787	160	150	250	210	199	161	54	484	98	386	16,830	1	24

USTR

Transition fitting EF coupler / steel pipe

Reference	Diameter	DN	A	B	D2	d3	h	L	t	z	Weight [kg]	BX	Pallet quantity
615030	180	150	250	-	227	161	50	500	105	395	21,250	1	18
612795	200	200	225	-	264	211	53	480	112	368	27,020	1	12
612370	225	200	225	-	285	211	76	505	120	385	27,350	1	11

¹ Pipe seamless, welded ends according to standard: DIN EN 10220/EN 10216-1, ASTM A106/A106M-14

USTR

Transition fitting EF coupler / steel pipe

Areas of Application

FRIALEN-Transition Fittings USTR are used for connection of HD-PE house connection pipe to the steel pipe of the house entry fitting. The larger dimensions connect an HD-PE pipeline to a steel fitting or steel pipeline.

FRIALEN safety fittings can be fused with SDR levels 11 to 17.6. Minimum wall thickness $s_{\text{minimum}} \geq 3 \text{ mm}$. Other SDR levels available on request. Please note the mandatory labels directly on the product. DVGW test mark issued with Reg. No.: DV-7501AU2256, DV-7501AU2257 and DV-7501AU2258

Assembly Instructions

Due to heat dissipation only arc welding is permissible. The fusion of the HD-PE side takes place by FRIALEN-fusing – leakproof and longitudinally strong.

Welding of the steel end and fusion of the HD-PE side have to be prepared according to the general installation instructions (see "Transition Fittings" in "Assembly Instructions" for "FRIALEN-Safety Fittings for house connections and distribution pipes up to d 225"). This involves removing the oxide skin and cleaning the pipe ends.

Good reasons for using the FRIALEN-USTR:

- Compact construction
- HD-PE side with exposed heating element for optimal heat transfer
- Cold zones at the end to prevent the flow of molten material
- No holding clamps required
- Large insertion depth, extra wide fusion zones
- Steel end permanently anchored in the HD-PE and will not distort
- Self sealing patented sealing geometry without elastomer seal
- Additional barcode for tracing back the underground fitting (Traceability-Coding)