

WUN 90

Transition elbow 90° HD-PE/brass with male thread

Transition elbow brass pipe WUN 90

- Water
- Working pressure: PFA (water) 16 bar
- Material: PE 100-RC and brass (EN 12168 - CW617N, thread according to EN 10226-1)
- Safety technology

Note:

The brass side is anchored as non-detachable and non-rotatable in PE.

Self-sealing, patented sealing geometry without elastomeric seal for utilisation in water areas.

Default: Brass, gunmetal on request.

Other thread dimensions available on request.

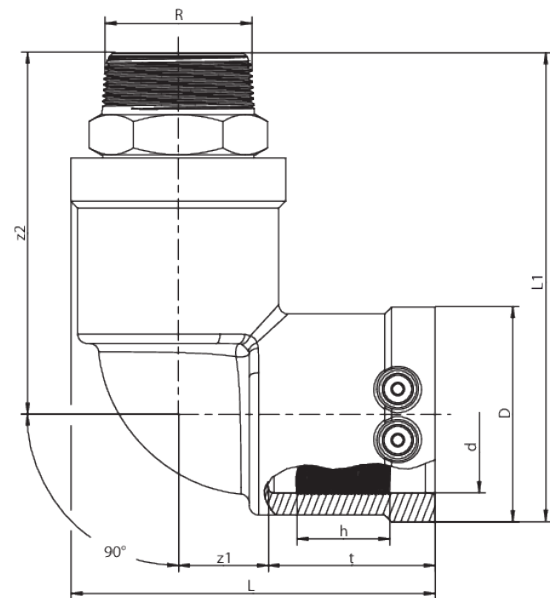

PE 100-RC SDR 11

Maximum permissible working pressure 16 bar (water)



Reference	Diameter	R	D	h	L	t	z ₁	z ₂	Weight [kg]	BX	Pallet quantity
612120	32	1"	47	24	85	42	21	89	0,350	20	1000
612140	32	1 1/2"	47	24	94	42	21	93	0,480	20	800
612127	40	1"	58	30	102	46	27	101	0,520	15	750
612122	40	1 1/4"	58	30	102	46	27	103	0,530	15	750
612121	40	1 1/2"	58	30	102	46	27	104	0,560	15	750
612119	50	1"	70	30	118	53	30	110	0,680	10	500
612123	50	1 1/4"	70	30	118	53	30	112	0,660	10	500
612124	50	1 1/2"	70	30	118	53	30	113	0,680	10	500

WUN 90

Transition elbow 90° HD-PE/brass with male thread

Reference	Diameter	R	D	h	L	t	z ₁	z ₂	Weight [kg]	BX	Pallet quantity
612125	63	1 1/2"	84	35	128	53	33	116	0,990	10	320
612126	63	2"	84	35	128	53	33	121	1,030	10	320

WUN 90

Transition elbow 90° HD-PE/brass with male thread

Areas of Application

FRIALEN-Transition Elbows WUN 90° are threaded joints as an adaptor from a metal pipe with internal thread to a HD-PE pipe. Joint on the part of HD-PE by FRIALEN-Coupler.

Other thread dimensions on request

FRIALEN safety fittings can be fused with SDR11 - SDR17,6 pipes, minimum wall thickness $s_{\text{minimum}} \geq 3$ mm. Other levels of SDR can be processed on request. Please note the mandatory labels directly on the product. DVGW test mark issued: DV-7501AU2256

Default: Brass. Gunmetal and V2A on request.

Assembly Instructions

The threaded component must be held with a spanner to prevent it twisting in the HD-PE component. The fusion of the HD-PE side takes place by FRIALEN-fusing – leakproof and longitudinally strong.

The installation of the brass and the HD-PE side has to be prepared according to the general installation instructions (see "Transition Fittings with threaded connection" in "Assembly Instructions" for "FRIALEN-Safety Fittings for house connections and distribution pipes up to d 225"). This involves removing the oxide skin and cleaning the pipe ends.

Good reasons for using the FRIALEN-Transition Elbows WUN 90°:

- Compact construction
- HD-PE side with exposed heating element for optimal heat transfer
- Cold zones at the end to prevent the flow of molten material
- No holding clamps required
- Large insertion depth, extra wide fusion zones
- Brass end permanently anchored in the HD-PE and will not distort
- Self sealing patented sealing geometry without elastomer seal
- Additional barcode for tracing back the underground fitting (Traceability-Coding)