

MR SDR 11

Reducer, SDR 11

Reducer MR, SDR 11

- Gas, water and H₂
- Working pressure: MOP (gas) 10 bar, PFA (water) 16 bar
- Material: PE 100-RC
- Safety technology
- Large insertion depth for good pipe routing (no holding devices required)
- DVGW test mark: DV-8601AU2248 and DV-8606AU2249
- FM Approvals Class: 1613 (d 90/63 - d 110/63 + d 110/90 - d 125/90 + d 160/110 - d 225/160)

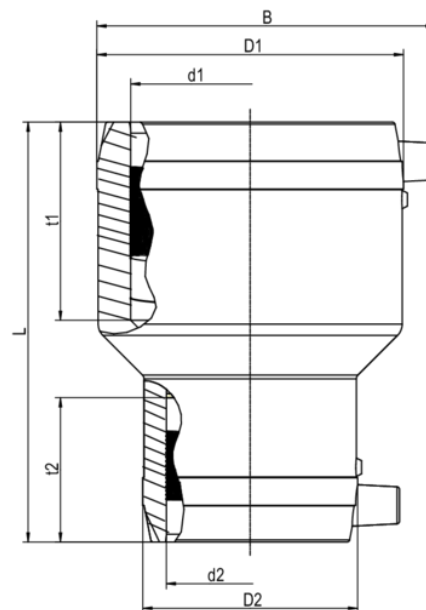

PE 100-RC / PE 100 SDR 11

Maximum permissible working pressure 16 bar (water) / 10 bar (gas)



Reference	d ₁	d ₂	SDR range	B	D1	D2	L	t ₁	t ₂	Weight [kg]	BX	Pallet quantity
616824	20	16	11	44	20	28	75	36	36	0,040	1	2240
616452	32	16	11	62	32	28	91	39	34	0,080	80	2560
615386	32	20	11	62	32	32	88	39	30	0,070	90	2880
615502	32	25	11	62	32	38	88	39	33	0,080	80	2560
615387	40	20	11	70	40	32	98	43	30	0,090	60	1920
616751	40	25	11	66	40	38	101	50	40	0,090	1	1280
615388	40	32	11	70	40	45	98	43	39	0,100	50	1600
616752	50	25	11	77	50	38	107	52	39	0,120	1	960
612070	50	32	11	82	50	45	110	49	39	0,150	32	1024
612071	50	40	11	82	50	54	110	49	43	0,150	25	800
615389	63	32	11	96	63	45	125	55	44	0,210	20	640
615390	63	40	11	96	63	54	125	55	43	0,230	16	512

MR SDR 11

Reducer, SDR 11

Reference	d ₁	d ₂	SDR range	B	D1	D2	L	t ₁	t ₂	Weight [kg]	BX	Pallet quantity
612072	63	50	11 - 17,6	96	63	68	125	55	48	0,230	16	512
616583	75	63	11 - 17,6	110	75	79	143	61	55	0,300	15	270
615391	90	50	11 - 17,6	129	90	68	160	69	49	0,480	15	270
615392	90	63	11 - 17,6	129	90	82	160	69	55	0,510	15	270
616582	90	75	11 - 17,6	127	90	94	159	67	63	0,510	15	270
615393	110	63	11 - 17,6	152	110	82	160	79	55	0,730	10	180
615693	110	90	11 - 17,6	152	110	115	180	79	69	0,880	8	144
615694	125	90	11 - 17,6	166	125	115	200	86	69	0,990	8	144
616510	125	110	11 - 17,6	172	125	137	202	95	70	1,160	16	128
615695	160	110	11 - 17,6	207	160	140	230	98	79	2,000	8	64
616511	180	125	11 - 17,6	230	180	155	275	108	74	2,300	1	60
616356	225	160	11 - 17,6	283	225	203	270	110	98	4,860	1	36

MR SDR 11

Reducer, SDR 11

Areas of Application

The FRIALEN Electrofusion Reducer MR is applied for immediate pipe reduction within the pipe system.

FRIALEN safety fittings can be fused with SDR11 – SDR17.6 pipes, with the exception of dimensions d 125/110 and d 180/125. These can be fused with SDR9 – SDR26 pipes. Other levels of SDR can be processed on request. Please note the mandatory labels directly on the product. DVGW test marks issued: DV-8601AU2248 and DV-8606AU2249

Assembly Instructions

Fusing of pipe ends with the FRIALEN Electrofusion Reducers MR takes place by FRIALEN fusion – leakproof and longitudinally strong.

The pipe ends are prepared according to the general installation instructions (note "Assembly Instructions" for FRIALEN Safety Fittings for house connections and distribution pipes (remove oxide layer/clean).

Good reasons for using the FRIALEN Electrofusion Reducers MR:

- Large coupler depth for ease of pipe guiding (no holding clamps required)
- Extra wide fusion zones
- Maximum stability through great wall thickness
- Cold zones at the front side and in the middle of the coupler
- Exposed heating coil for direct heat transmission to the pipe
- Small annular gap for build-up of optimum joining pressure in the fusion zone
- Touch proof electric contacts
- Fusion indicator for visual fusion control
- Durable batch marking
- Individually wrapped for dirt protection
- Additional barcode for tracing back the underground fitting (Traceability-Coding)