

OAB - Flange ANSI series

Steel core flange, PP/FRP coated according to ANSI B16.5 cl.150 for QRC stubs.

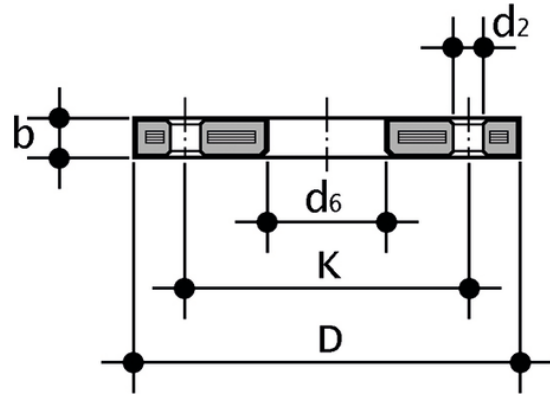

Reference	d (inch)	DN	b	d ₂ mm	d ₂ inch	d ₆	D	k (mm)	k(inch)	n	**Nm	g
OAB012	1/2"	15	12	16	5/8"	28	95	60,45	2"3/8	4	15	200
OAB034	3/4"	20	12	16	3/4"	34	69,85	2"3/4	4	15	240	5/8"
OAB100	1"	25	16	16	1"	42	79,2	3"1/8	4	15	490	5/8"
OAB114	1"1/4	32	16	16	1"1/4"	51	88,9	3"1/2	4	25	670	5/8"
OAB112	1"1/2	40	18	16	1"1/2"	62	98,55	3"7/8	4	35	640	5/8"
OAB200	2"	50	18	20	2"	78	120,65	4"3/4	4	35	1000	3/4"
OAB212	2"1/2	65	18	20	2"1/2"	92	139,7	5"1/2	4	40	1310	3/4"
OAB300	3"	80	18	20	3"	111	152,4	6"	4	40	1250	3/4"
OAB400	4"	100	18	20	4"	133	190,5	7"1/2	8	40	1660	3/4"
OAB814	*14"	355	42	376	14"	533	476,2	12	110	24940	28.5	1" 1/8
OAB816	*16"	400	44	430	16"	539.7	18" 13/32	16	110	34770	28.5	1" 1/8

All information subject to change.

Please contact us on <https://www.aliaxis.co.uk/get-in-touch> for further informations