

OABC - Flange ANSI series

Steel core blind flange, PP/FRP coated, according to ANSI B16.5 cl.150.

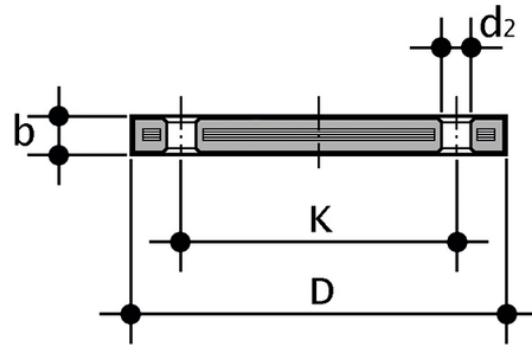

Reference	d (inch)	DN	B	D	d ₂ mm	d ₂ inch	k (mm)	k(inch)	**Nm	n	g
OABC012	1/2"	15	12	95	16	5/8"	60,45	2"3/8	15	4	200
OABC034	3/4"	20	12	102	16	5/8"	69,85	2"3/4	15	4	240
OABC100	1"	25	16	114	16	5/8"	79,25	3"1/8	15	4	370
OABC114	1"1/4	32	16	130	16	5/8"	88,90	3"1/2	25	4	530
OABC112	1"1/2	40	18	133	16	5/8"	98,55	3"7/8	35	4	560
OABC200	2"	50	18	162	20	3/4"	120,65	4"3/4	35	4	810
OABC212	2"1/2	65	18	184	20	3/4"	139,70	5"1/2	40	4	1070
OABC300	3"	80	18	194	20	3/4"	152,40	6"	40	4	1030
OABC400	4"	100	18	229	20	3/4"	190,50	7"1/2	40	8	1570

All information subject to change.

Please contact us on <https://www.aliaxis.co.uk/get-in-touch> for further informations