

# ODB - Flange ISO-DIN series

Steel core backing ring, PP/FRP coated, according to EN/ISO/DIN for stub QRNM. Drilling: PN 10/16.

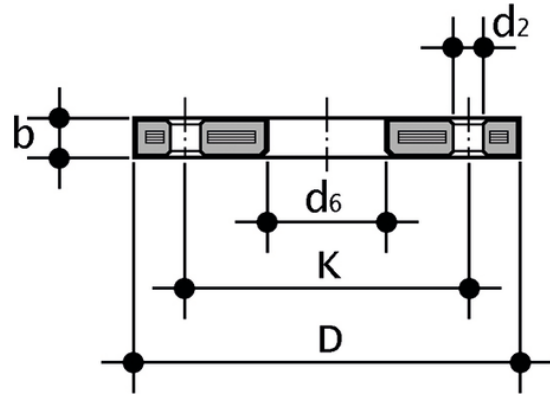

Reference	d	DN	*PMA (bar)	b	d <sub>2</sub>	d <sub>6</sub>	D	K	M	n	**Nm	g
ODB355	*355	350	10	39	22	376	505	460	M20	16	120	15580
ODB400	*400	400	10	44	26	429.5	570	515	M24	16	140	19890
ODB450	*450	500	10	44	26	517	670	620	M24	20	150	26010
ODB500	*500	500	10	44	26	532.5	670	620	M24	20	150	25310
ODB560	*560	600	10	50	30	618	799	725	M27	20	170	49500
ODB630	*630	600	10	50	30	645	799	725	M27	20	170	41190

All information subject to change.

Please contact us on <https://www.aliasis.co.uk/get-in-touch> for further informations