



ODBC - Steel core blind flange

Steel core blind flange, PP/FRP according to EN/ISO/DIN. Drilling: PN 10/16.

All information subject to change.

Please contact us on <https://www.aliaxis.co.uk/get-in-touch> for further informations



ODBC - Steel core blind flange

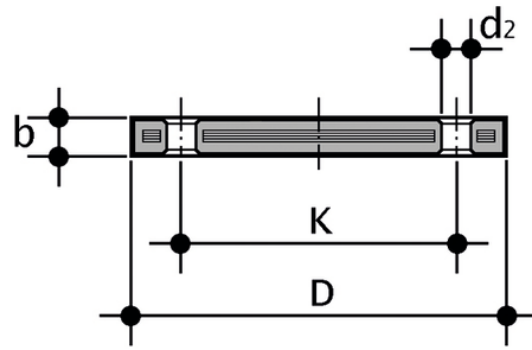

Reference	d	DN	*PMA (bar)	b	d ₂	D	k	M	n	**Nm	g
ODBC020	20	15	10	16	14	95	65	M12	4	15	290
ODBC025	25	20	10	12	18	105	75	M12	4	15	380
ODBC032	32	25	10	18	14	115	85	M12	4	15	600
ODBC040	40	32	10	17	18	140	100	M16	4	25	830
ODBC050	50	40	10	18	18	150	110	M16	4	35	1105
ODBC063	63	50	10	18	18	165	125	M16	4	35	1308
ODBC075	75	65	10	18	18	185	145	M16	4	40	1580
ODBC090	90	80	10	20	18	200	160	M16	8	40	2244
ODBC110	110	100	10	20	18	220	180	M16	8	45	2829

All information subject to change.

Please contact us on <https://www.aliaxis.co.uk/get-in-touch> for further informations