

# CROV - Wafer check valve DN 40:300

Wafer check valve in PVC-U/EPDM.

The CR wafer check valve is designed to be installed directly between stubs and flanges in accordance with ISO/DIN standards.

- Installed with FIP QPV (d50 - d160) stubs and QRV stubs using flat gasket QHV/Y (d225 - d315), on PVC piping class PN10 or lower with type ODV flanges
- **Metal support for easy and precise centring** of the valve during installation
- Can be installed in either a vertical or horizontal position
- **Sealing system with O-ring** for optimum sealing and installation without flat gaskets

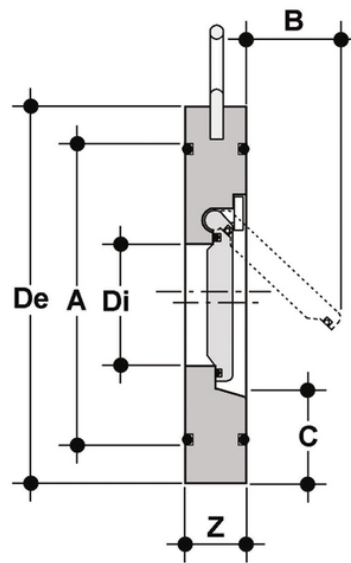

Reference	d	DN	A	B	C	De ISO/DIN	Di	OP	Z	g	*MOP (bar)
CROV050E	50	40	72	25	28	95	22	0-5	16	160	6
CROV063E	63	50	86	37	29	109	32	0-5	20	260	6
CROV075E	75	65	105	50	31	129	40	0-5	20	330	6
CROV090E	90	80	119	61	32	144	54	0-5	20	400	6
CROV110E	110	100	146	77	31	164	70	0-5	22	560	6
CROV140E	140	125	173	94	35	195	92	0-5	23	760	6
CROV160E	160	150	197	100	40	220	105	0-5	25	1120	6
CROV225E	225	200	255	152	38	275	154	0-5	35	2130	6
CROV280E	280	250	312	180	41	330	192	0-5	40	3540	6
CROV315E	315	300	363	215	41	380	227	0-5	45	5350	6

All information subject to change.

Please contact us on <https://www.aliasis.co.uk/get-in-touch> for further informations