

# QPV special flat for butterfly valves

Solvent weld fittings - stubs.

Special flat stub in PVC-U for butterfly valve d140 and d225 on d125 and d200 pipe.

Series of fittings designed for conveying fluids under pressure with a cold chemical weld joining system (solvent welding) using a suitable solvent cement and cleaner-primer.

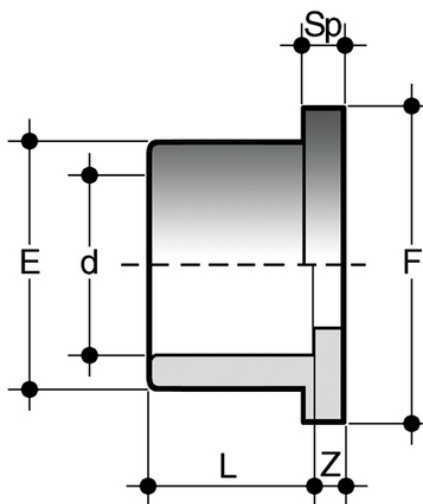

Reference		d	DN	PN	E	F	L	Sp	Z	g	To be used with valves series:
QPV125FKE	I	*125	125	16	165	188	69	13	11	760	FE - FK
QPV200FKE	**200	200	16	248	273	106	30	24	2700	FE - FK	

All information subject to change.

Please contact us on <https://www.aliaxis.co.uk/get-in-touch> for further informations