

LIV

Adaptor fittings - tank connectors.

Tank connector with solvent weld spigot d, threaded joint R with tightening nut and flat gasket in EPDM.

Series of fittings designed for conveying fluids under pressure with threaded and solvent weld cold chemical jointing systems (solvent welding) using suitable solvent cement and cleaner/primer.

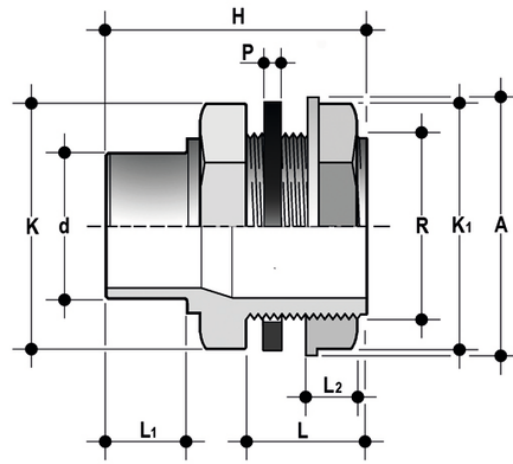

Reference	d x R	PN	A	H	K	K[5:1]	L	L ₁	L ₂	P	g
LIV025100	25 x 1"	16	58	60	46	46	26	19	16	2	58
LIV032114	32 x 1 1/4"	16	62	66	55	50	28	22	18	2	90