

SAFL

Saddle with flanged outlet, SDR 11

Saddle with flanged outlet SAFL SDR 11

- Gas and water
- Working pressure: MOP (gas) 10 bar, PFA (water) 16 bar
- Material: PE 100-RC
- Saddle component with clamp and flange
- Tapping under pressure possible
- Safety technology
- DVGW test mark: DV-8606AU2249

Note:

For pressure-free tapping, we recommend our FWAB drilling device.

For tapping under pressure, we recommend the drilling tool from Hütz & Baumgarten (www.huetz-baumgarten.de).

Note the screw tightening torques after specifying the seal manufacturer and/or DVS and the utilisation of a GST seal.

If required, please contact our hotline: +49 621 486-2325.

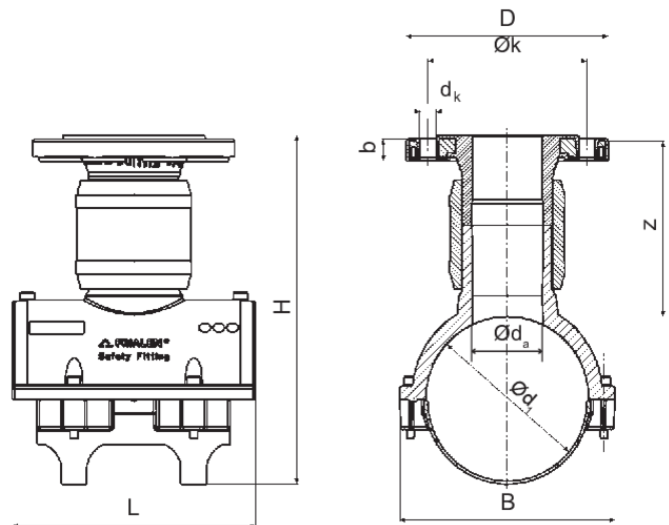

PE 100-RC SDR 11

Maximum permissible working pressure 16 bar (water) / 10 bar (gas)



Reference	d ₁	B	b	D	D1	dk	H	k	L	Z	Drilling Ø da	Weight [kg]	BX	Pallet quantity
616016	110	165	25	204	110	16,5	296	160	190	180	65	3,710	3	54
616017	125	185	25	204	125	16,5	311	160	205	180	65	3,940	2	36
616018	160	217	25	204	160	16,5	346	160	245	180	65	4,320	2	36
616019	180	241	25	204	180	16,5	366	160	285	180	65	4,610	2	36
616020	225	286	25	204	225	16,5	411	160	284	180	65	4,720	2	16

SAFL

Saddle with flanged outlet, SDR 11

Reference	c ₁	B	b	D	D1	dk	H	k	L	Z	Drilling Ø da	Weight [kg]	BX	Pallet quantity
616022	160	217	27	224	160	16,5	346	180	245	180	84	5,270	2	36
616024	225	286	27	224	225	16,5	411	180	284	180	84	5,640	2	16

SAFL

Saddle with flanged outlet, SDR 11

Areas of Application

The FRIALEN Spigot Saddle with Flange Outlet SAFL is used for the integration of flange valves and hydrants up to PN 16.

FRIALEN safety fittings can be fused with pipes with SDR levels 11 to 17.6. Other levels of SDR can be processed on request. Please note the mandatory labels directly on the product. DVGW test mark issued: DV-8606AU2249

Assembly Instructions

The saddle of the SAFL is mounted and fused onto the HD-PE mains. Drilling into the HD-PE mains can take place

- without pressure in the mains
- under operating pressure on application of a gate-valve on the flange side

using standard drill equipment. We recommend Hütz + Baumgarten.

The fusion of the saddle piece with the HD-PE mains takes place using FRIALEN-fusion – leakproof and longitudinally strong. Saddle and HD-PE mains are prepared according to the general installation instructions (see Assembly Instructions for "FRIALEN-Safety Fittings for house connections and distribution pipes up to d 225"). This involves removing oxide skin.

The flange connection measurements correspond to DIN EN 1092-1. Supplementary washers are required.

All standard profile and flat gaskets can be used. Torques advised by the gasket manufacturer must be observed. We recommend profile gaskets of type G-St.

Good reasons for using the FRIALEN Saddle with flanged outlet SAFL:

- Compact component from HD-PE
- Flange adaptor and flange are one component. They make up one homogeneous unit
- Factory made combination of FRIALEN-Spigot Saddle, FRIALEN-Coupler and Full Faced Flange
- Smooth on the inside and no fusion bead at the connection between SA and EFL, optimum hydraulics
- The cold flowing properties well known with HD-PE are avoided by constructive flange design
- Solid construction. Integration of the flange prevents tear-off
- Short overall length for horizontal and vertical installation
- Top stability due to great wall thickness
- Extremely economical solution
- Additional barcode for tracing back the underground fitting (Traceability-Coding)