

RS

Repair Saddle, SDR 11

Repair saddle RS SDR 11

- Gas, water and H₂
- Working pressure: MOP (gas) 10 bar, PFA (water) 16 bar
- Material: PE 100-RC
- Saddle component with clamp
- Safety technology

Note:

Only apply to minor pipe damage.

The damage must be located within the repair area and not in the fusion zone.

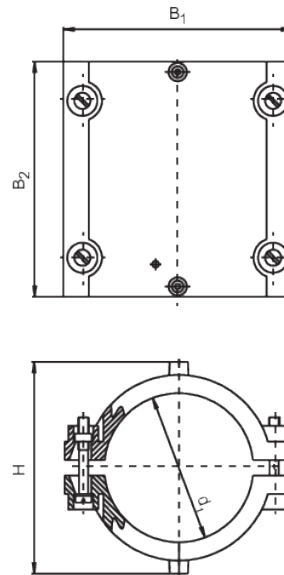

PE 100-RC SDR 11

Maximum permissible working pressure 16 bar (water) / 10 bar (gas)



	Reference	d ₁	B1	B2	D1	H	Weight [kg]	BX	Pallet quantity
1	612519	63	105	104	63	106	0,270	20	360

¹ d 63 can only be fused with pipes of the SDR level 11.

RS

Repair Saddle, SDR 11

Areas of Application

The FRIALEN-Repair Saddles are used to repair small pipe damage without media leakage, especially to reinforce squeezed zones and areas with external damage.

FRIALEN safety fittings are fusion-capable with PE pipes according to the specifications of the SDR pipe series on the barcode sticker/datasheet of the respective fitting. The minimum wall thicknesses specified in the standards EN1555-1, EN 12201-1 and ISO 4437 must be observed.

Assembly Instructions

The fusion of the HD-PE pipe with FRIALEN-Repair Saddles are carried out by FRIALEN-fusing - tight and longitudinally force-locking.

Both saddle are prepared according to the general assembly requirements (see assembly instructions: „FRIALEN safety fittings for sustainable pipes for gas, water networks and industrial systems made of PE“) (remove/clean oxide layer from pipe).

Good reasons for using the FRIALEN-RS:

- Compact construction
- Open wire technology for direct heat transmission
- Preassembled unit without loose parts
- Wide fusion zone
- Additional barcode for tracing back the fitting (Traceability-Coding)