

SPA TL

Balloon shut off saddle top-loading

Balloon shut off saddle top-loading SPA TL

- Gas, water and H₂
- Working pressure: MOP (gas) 10 bar, PFA (water) 16 bar
- Material: PE 100-RC and brass
 - Universal clamping option (top loading):
 - Safe clamping with FRIATOP
- Safety technology

Note:

Can only be used with the clamping device FRIATOP (Order No. 613350). Brass female and male threads are anchored in the HD-PE in a non-detachable and non-rotatable manner.

Including brass plug with recessed square. For the accommodation of commercially available bubble setting devices.

Access protection for the dome by means of the supplied screw cap or by fusion on a FRIALEN SPAK.

When using hydrogen, the SPA balloon shut off saddle is only available in conjunction with the closure cap SPAK (Order No. 612311).

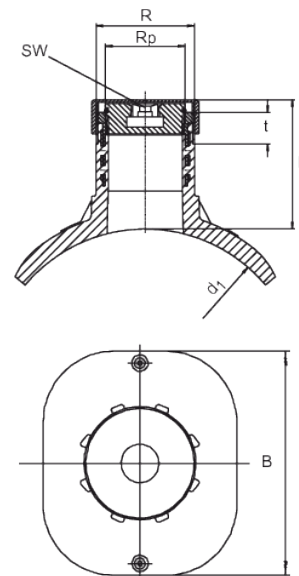

PE 100-RC SDR 11

Maximum permissible working pressure 16 bar (water) / 10 bar (gas)



Reference	R	d ₁	R _p	B	D1	L	t	Drilling Ø da	SW	Weight [kg]	BX	Pallet quantity
615395	2 1/2"	250-355 (560)	2"	200	250-355 (560)	115	24	56,5	19	1,360	18	144

SPA TL

Balloon shut off saddle top-loading

Areas of Application

FRIALEN balloon shut-off Saddle SPA TL is suitable for normal commercial shut off equipment.

The fusion range of the FRIALEN SPA TL balloon shut-off saddle covers the dimensions d 250 - d 560. If necessary, application-related restrictions must be taken into account, e.g. due to the drill tool or balloon shut-off which is utilised.

Always observe the manufacturer's instructions for these components!

FRIALEN safety fittings can be fused with SDR levels 11 to 17.6. Other SDR levels available on request. Please note the mandatory labels directly on the product. DVGW test mark issued: DV-8611AU2250

Assembly Instructions

The saddle is clamped onto the pipe with the FRIATOP clamping device (see pricelist "Technical Equipment"). Please read the "Assembly and Operating Instructions for FRIATOP clamping unit (Top-Loading)".

The fusion of the HD-PE mains and the FRIALEN Shut off Saddle Top-Loading takes place by FRIALEN-fusing – leakproof and longitudinally strong.

The pipe and the saddle have to be prepared according to the general installation instructions (see Assembly Instructions for "FRIALEN Large Pipe Technique for laying large pipes and relining pipe networks"). This involves removing the oxide skin and cleaning the pipe covered by the saddle.

Good reasons for using the FRIALEN Shut off Saddle SPA TL:

- Compact construction
- HD-PE saddle with exposed heating element for optimal heat transfer
- Compact part suitable for normal commercial shut off equipment for tapping through the saddle
- Brass-guide thread permanently and immovable anchored in the HD-PE
- Includes brass plug with square recess
- Protection against access to the dome by fusing on a FRIALEN SPAK
- The SPA TL can be applied universally to large HD-PE pipe diameters d 250-355 (560). This means additional economy due to less material needed and less stock both with suppliers and trade
- Additional barcode for tracing back the underground fitting (Traceability-Coding).