

# WRKR

## Raccord réducteur Wide-Range (pièce en U)

Raccord de réduction pour le raccordement de tuyaux de différents matériaux (acier, fonte, fonte ductile, amiante-ciment, PVC, PE-HD/PEX).

- Corps et bague de suivi en acier
- Protection anticorrosion Rilsan (min. 250 µm selon GSK)
- Vis et écrous galvanisés/revêtus de sheraplex ou en acier inoxydable
- Matériau du joint EPDM
- Tolérance de diamètre max. 17 mm
- Possibilité de couder les tubes de 6 degrés max.
- Plage de température : -20°C - +30°C

### Remarque:

Pour l'application sur des tubes PE-HD/PEX, notre douille de soutien interne SHVA est nécessaire. Comme alternative, nous recommandons le produit FRIAGRIP à adhérence longitudinale.

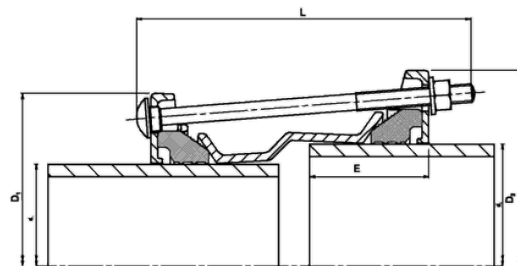

Référence	product.detail.attribute.d1Small	product.detail.attribute.d2Small	product.detail.attribute.weight	product.detail.attribute.packUnit
GB-99R9-315351	315,0-332,0	351,0-368,0	44,000	1
GB-99R9-315367	315,0-332,0	367,0-384,0	22,300	1
GB-99R9-351374	351,0-368,0	374,5-391,5	32,400	1
GB-99R9-374394	374,5-391,5	394,3-411,3	34,500	1
GB-99R9-374404	374,5-391,5	404,8-421,8	36,500	1
GB-99R9-394418	394,3-411,3	418,2-435,2	36,500	1
GB-99R9-394425	394,3-411,3	425,0-442,0	35,600	1
GB-99R9-404425	404,8-421,8	425,0-442,0	38,800	1
GB-99R9-425434	425,0-442,0	434,4-451,4	38,900	1

## Raccord réducteur Wide-Range (pièce en U)

Référence	product.detail.attribute.d1Small	product.detail.attribute.d2Small	product.detail.attribute.weight	product.detail.attribute.packUnit
GB-99R9-425447	425,0-442,0	447,0-464,0	39,100	1
GB-99R9-425455	425,0-442,0	455,0-472,0	39,500	1
GB-99R9-425476	425,0-442,0	476,0-493,0	39,500	1
GB-99R9-425487	425,0-442,0	487,0-504,0	68,000	1
GB-99R9-447455	447,2-464,2	455,0-472,0	49,500	1
GB-99R9-447476	447,2-464,2	476,0-493,0	43,000	1
GB-99R9-447501	447,2-464,2	501,9-518,9	43,000	1
GB-99R9-447510	447,2-464,2	510,0-527,0	43,600	1
GB-99R9-447540	447,2-464,2	540,1-557,1	47,400	1
GB-99R9-476487	476,0-493,0	487,3-504,3	42,700	1
GB-99R9-476501	476,0-493,0	501,9-518,9	43,000	1
GB-99R9-476510	476,0-493,0	510,0-527,0	43,600	1
GB-99R9-487527	487,0-504,0	527,0-544,0	47,700	1
GB-99R9-501527	501,0-518,0	527,0-545,0	47,700	1
GB-99R9-510527	510,0-527,0	527,0-545,0	47,700	1
GB-99R9-528540	527,0-544,0	540,1-557,1	47,400	1
GB-99R9-528555	527,0-544,0	555,3-572,3	47,600	1
GB-99R9-528566	527,0-544,0	566,5-583,5	47,800	1
GB-99R9-528582	527,0-544,0	582,2-599,2	48,000	1
GB-99R9-527598	527,0-544,0	598,0-615,0	48,000	1
GB-99R9-527601	527,0-544,0	601,0-618,0	48,000	1
GB-99R9-527630	527,0-544,0	630,0-647,0	48,000	1
GB-99R9-555566	555,3-572,3	566,5-583,5	47,800	1
GB-99R9-598630	598,0-615,0	630,0-647,0	56,100	1
GB-99R9-601630	601,0-618,0	630,0-647,0	56,100	1
GB-99R9-630645	630,0-647,0	645,2-662,2	55,800	1
GB-99R9-630662	630,0-647,0	662,0-679,0	56,100	1
GB-99R9-630675	630,0-647,0	675,0-692,0	57,000	1

Référence	product.detail.attribute.d1Small	product.detail.attribute.d2Small	product.detail.attribute.weight	product.detail.attribute.packUnit
GB-99R9X315351	315,0-332,0	351,0-368,0	32,100	1
GB-99R9X315367	315,0-332,0	367,0-384,0	22,300	1
GB-99R9X351374	351,0-368,0	374,5-391,5	34,200	1
GB-99R9X374394	374,5-391,5	394,3-411,3	34,500	1
GB-99R9X374404	374,5-391,5	404,8-421,8	36,500	1

## Raccord réducteur Wide-Range (pièce en U)

Référence	product.detail.attribute.d1Small	product.detail.attribute.d2Small	product.detail.attribute.weight	product.detail.attribute.packUnit
GB-99R9X394418	394,3-411,3	418,2-435,2	36,500	1
GB-99R9X394425	394,3-411,3	425,0-442,0	37,500	1
GB-99R9X404425	404,8-421,8	425,0-442,0	37,500	1
GB-99R9X425434	425,0-442,0	434,4-451,4	38,900	1
GB-99R9X425447	425,0-442,0	447,0-464,0	39,100	1
GB-99R9X425455	425,0-442,0	455,0-472,0	39,500	1
GB-99R9X425476	425,0-442,0	476,0-493,0	55,000	1
GB-99R9X425487	425,0-442,0	487,0-504,0	68,000	1
GB-99R9X447455	447,2-464,2	455,0-472,0	39,500	1
GB-99R9X447476	447,2-464,2	476,0-493,0	43,000	1
GB-99R9X447501	447,2-464,2	501,9-518,9	43,000	1
GB-99R9X447510	447,2-464,2	510,0-527,0	43,600	1
GB-99R9X447540	447,2-464,2	540,1-557,1	47,400	1
GB-99R9X476487	476,0-493,0	487,3-504,3	42,700	1
GB-99R9X476501	476,0-493,0	501,9-518,9	43,000	1
GB-99R9X476510	476,0-493,0	510,0-527,0	43,600	1
GB-99R9X487527	487,0-504,0	527,0-545,0	47,700	1
GB-99R9X501527	501,0-518,0	527,0-545,0	47,700	1
GB-99R9X510527	510,0-527,0	527,0-545,0	47,700	1
GB-99R9X528540	527,0-544,0	540,1-557,1	47,400	1
GB-99R9X528555	527,0-544,0	555,3-572,1	47,600	1
GB-99R9X528566	527,0-544,0	566,5-583,5	47,800	1
GB-99R9X528582	527,0-544,0	582,2-599,2	48,000	1
GB-99R9X527598	527,0-544,0	598,0-615,0	63,000	1
GB-99R9X527601	527,0-544,0	601,0-618,0	48,000	1
GB-99R9X527630	527,0-544,0	630,0-647,0	48,000	1
GB-99R9X555566	555,3-572,3	566,5-583,5	47,800	1
GB-99R9X598630	598,0-615,0	630,0-647,0	56,100	1
GB-99R9X601630	601,0-618,0	630,0-647,0	56,100	1
GB-99R9X630645	630,0-647,0	645,2-662,2	55,800	1
GB-99R9X630662	630,0-647,0	662,0-679,0	56,100	1
GB-99R9X630675	630,0-647,0	675,0-692,0	57,000	1