

NFV

Raccords filetés - extrémités égales.

Extrémités filetées mâles.

Série de raccords destinés au transport de fluides sous pression avec connexion filetée.

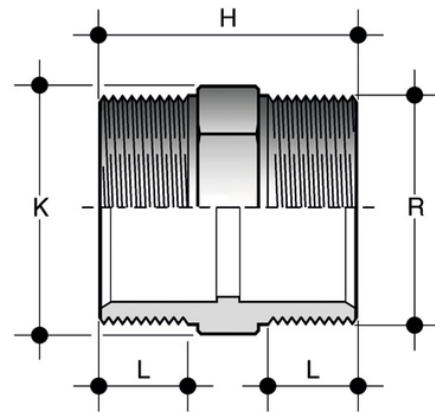

Référence	product.detail.attribute.[["R"
NFV038	3\8"
NFV012	1\2"
NFV034	3\4"
NFV100	1"
NFV114	1\1\4",["PN","16"],["E","52"],["H","58"],["K","46"],["L","21,4"],["g","45"]
NFV112	1\1\2",["PN","16"],["E","58"],["H","58"],["K","50"],["L","21,4"],["g","63"]
NFV200	2"
NFV212	2\1\2",["PN","16"],["E","-"],["H","78"],["K","80"],["L","30,2"],["g","175"]
NFV300	3"
NFV400	4"