

OABC - Flangia serie ANSI

Flangia cieca in acciaio rivestito di PP/FRP ANSI B16.5 cl.150.

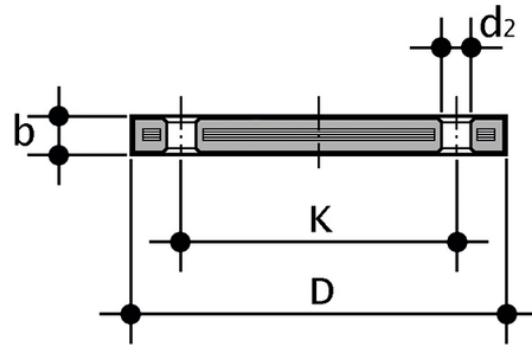

| Codice | d (pollici) | DN | B | D | d ₂ mm | d ₂ inch | k (mm) | k(inch) | **Nm | n | g |
|---------|-------------|-----|----|-----|-------------------|---------------------|--------|---------|------|---|------|
| OABC012 | 1/2" | 15 | 12 | 95 | 16 | 5/8" | 60,45 | 2"3/8 | 15 | 4 | 200 |
| OABC034 | 3/4" | 20 | 12 | 102 | 16 | 5/8" | 69,85 | 2"3/4 | 15 | 4 | 240 |
| OABC100 | 1" | 25 | 16 | 114 | 16 | 5/8" | 79,25 | 3"1/8 | 15 | 4 | 370 |
| OABC114 | 1"1/4 | 32 | 16 | 130 | 16 | 5/8" | 88,90 | 3"1/2 | 25 | 4 | 530 |
| OABC112 | 1"1/2 | 40 | 18 | 133 | 16 | 5/8" | 98,55 | 3"7/8 | 35 | 4 | 560 |
| OABC200 | 2" | 50 | 18 | 162 | 20 | 3/4" | 120,65 | 4"3/4 | 35 | 4 | 810 |
| OABC212 | 2"1/2 | 65 | 18 | 184 | 20 | 3/4" | 139,70 | 5"1/2 | 40 | 4 | 1070 |
| OABC300 | 3" | 80 | 18 | 194 | 20 | 3/4" | 152,40 | 6" | 40 | 4 | 1030 |
| OABC400 | 4" | 100 | 18 | 229 | 20 | 3/4" | 190,50 | 7"1/2 | 40 | 8 | 1570 |